

Trade / Warehouse To Let

CORE
COMMERCIAL
01892 834483



**Unit C3, Cuxton Road
Parkwood**

MAIDSTONE
Kent ME15 9YF

Location

Maidstone is the county town of Kent 35 miles Southeast of London. Cuxton Road is the first road right on Bircholt Road, off the A274 Sutton Road southeast of Maidstone town centre.

Description

A modern industrial and warehouse unit currently used as a leisure unit. Full mezzanine floor. 3 phase power. Roller shutter. W/c's, shower and kitchen. Normal hours of use. Glazed entrance with security shutter. 4 car parking spaces plus loading area. No gym uses allowed as outgoing gym expanding to a larger unit on site.

Ground	1,780
Mezzanine	1,662
	3,442 sqft

Terms

To let on a new lease at **£22,500** pa plus vat. Rates payable £6,986 for 2020/21 (Rateable Value £14,000).



3,442 sqft

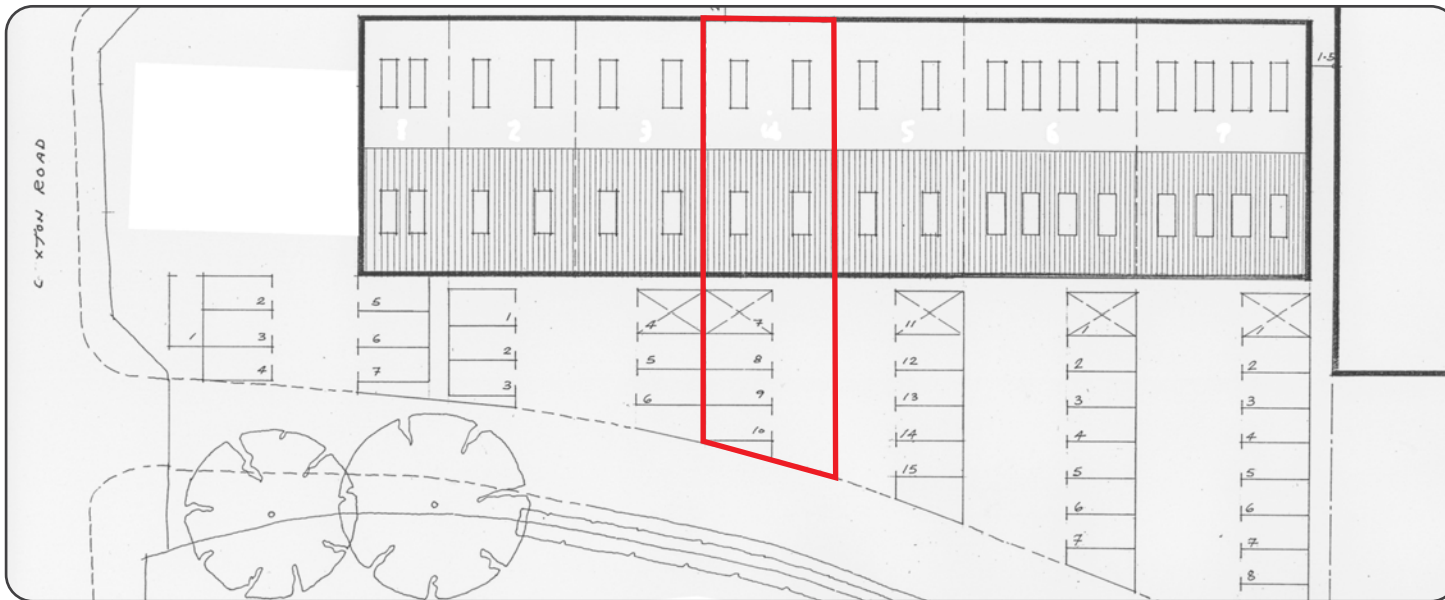
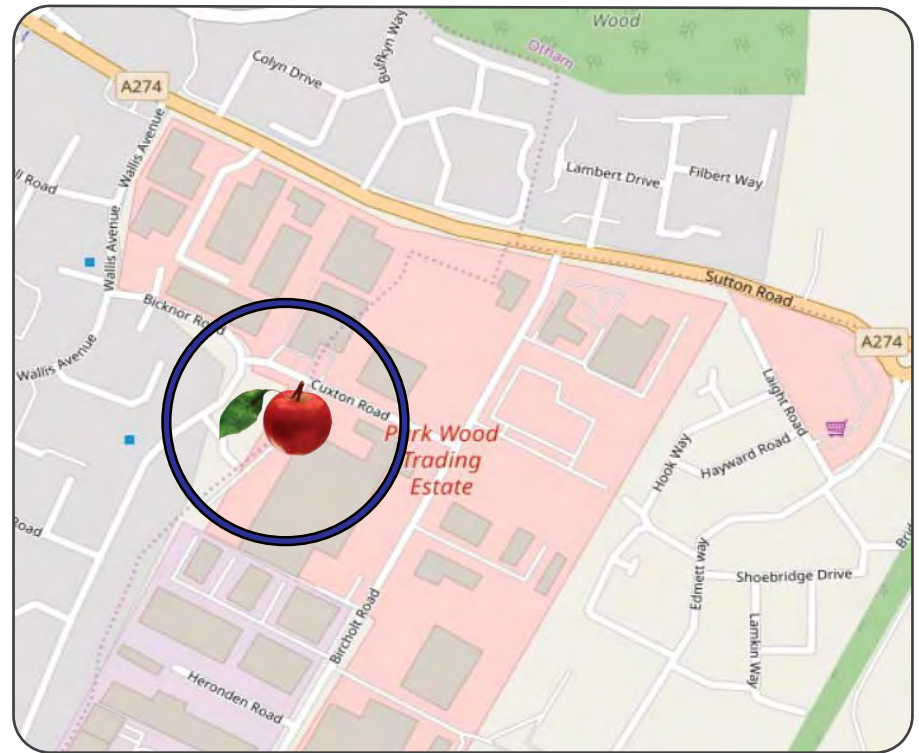
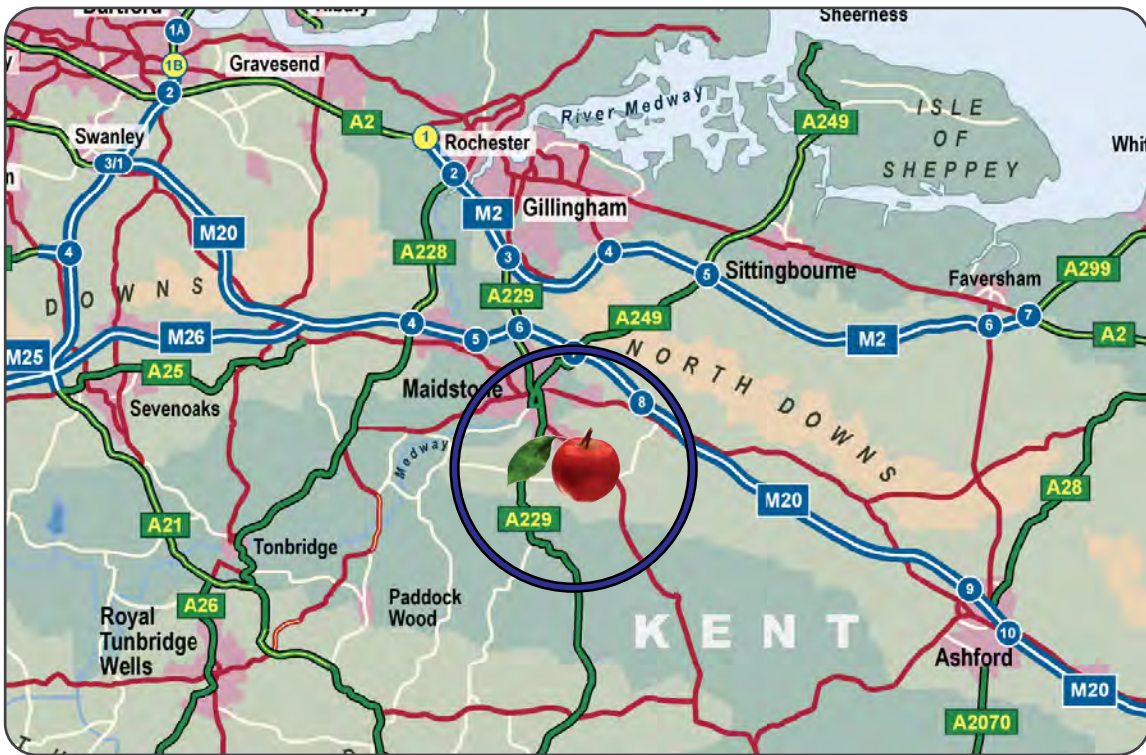

CORE
COMMERCIAL
01892 834483
www.CoreCommercial.co.uk

David Marriott
 David@CoreCommercial.co.uk
Neil Mason
 Neil@CoreCommercial.co.uk

These particulars are provided in good faith but do not form part of a contract. No statements are to be relied upon as statements of fact and parties intending to rely upon the information for any purpose whatsoever must satisfy themselves by inspection or otherwise as to the correctness of each statement.

Core Commercial Limited, Unit 11 Offices, Dana Estate
Transfesa Road, Paddock Wood, Kent TN12 6UT

