

Trade / Warehouse To Let



**Unit C5, Cuxton Road
Parkwood**

MAIDSTONE
Kent ME15 9YF

Location

Maidstone is the county town of Kent 35 miles Southeast of London. Cuxton Road is the first road right on Bircholt Road, off the A274 Sutton Road southeast of Maidstone town centre.

Description

A modern trade, factory and warehouse unit. 20ft eaves height (25ft peak). 3 phase power. Normal hours of use. Electric office heating, suspended ceilings and recessed lighting. Sodium high bay lighting and 10% roof lights to warehouse. Disabled and 2nd toilet. Kitchen. Glazed trade entrance with security shutter. 7 car parking spaces plus loading area.

Trade counter	762
Warehouse	1,544
	2,306 sqft
Mezzanine store	785 sqft

Terms

To let on a new lease at **£22,500** pa plus vat.
Rates payable £8,982 for 2021/22 (Rateable Value £18,000).



CORE
COMMERCIAL
Trade Warehouse
2,300 sq ft
TO LET
01892 834483
www.CoreCommercial.co.uk

2,300 sqft



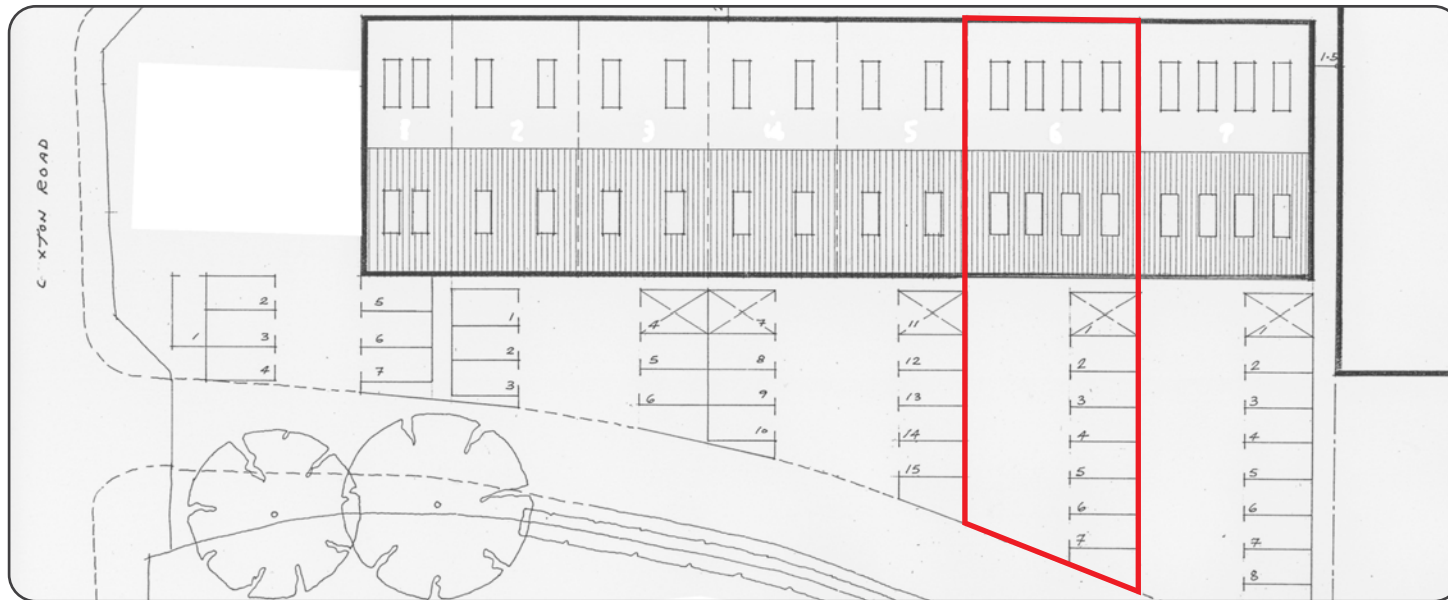
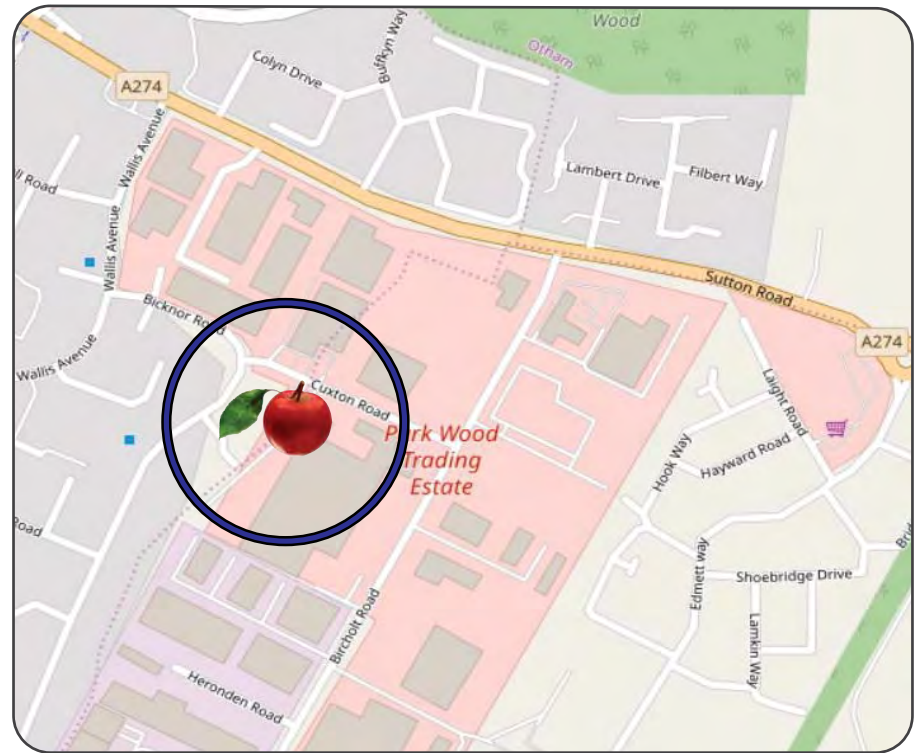
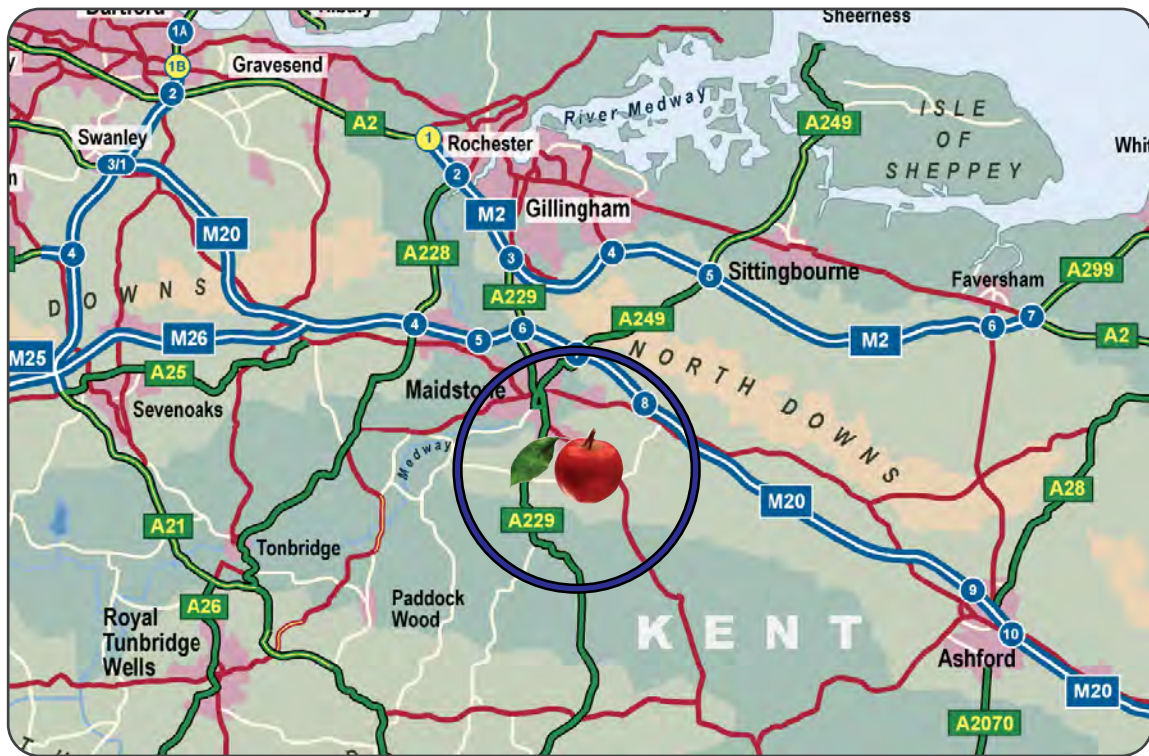

CORE
COMMERCIAL
01892 834483
www.CoreCommercial.co.uk

Neil Mason
 Neil@CoreCommercial.co.uk
David Marriott
 David@CoreCommercial.co.uk

These particulars are provided in good faith but do not form part of a contract. No statements are to be relied upon as statements of fact and parties intending to rely upon the information for any purpose whatsoever must satisfy themselves by inspection or otherwise as to the correctness of each statement.

Core Commercial Limited, Unit 11 Offices, Dana Estate
 Transfesa Road, Paddock Wood, Kent TN12 6UT