

Factory / warehouse For sale



**7,460 sqft
on 0.5 acre site**

**The Packhouse
Queen Street**

PADDOCK WOOD

Kent TN12 6PJ

Location

Paddock Wood lies on the A228 between Tunbridge Wells (5 miles) and Maidstone (10 miles), 4 miles to the east of Tonbridge. The property lies in a rural position about 2 miles east of the town.

Description

A former packhouse of steel frame / truss construction with brick and corrugated cladding. Roller shutter doors. 3 phase power. Mains drainage. Eaves height from 16'4". Subdivisible into 5 separate units.

The premises have planning permission for B1 (light industrial) and B8 (storage and distribution) uses with a restriction to use only during normal business hours. MA/05/1537. Gross internal areas:

Ground	6,285
Mezzanine offices / stores	1,173
	7,458 sqft

Site area 0.5 acre

Terms

For sale freehold **£315,000** (£50 per sqft on the ground floor only) subject to contract. Rates payable £9,303 pa for 2013/14 - (Rateable Value £19,750).



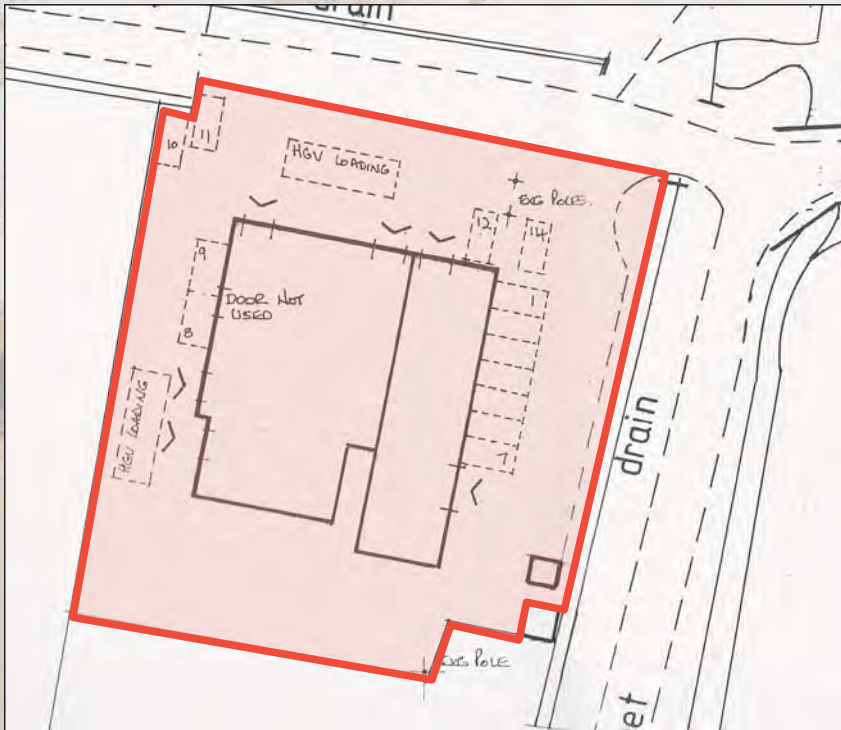
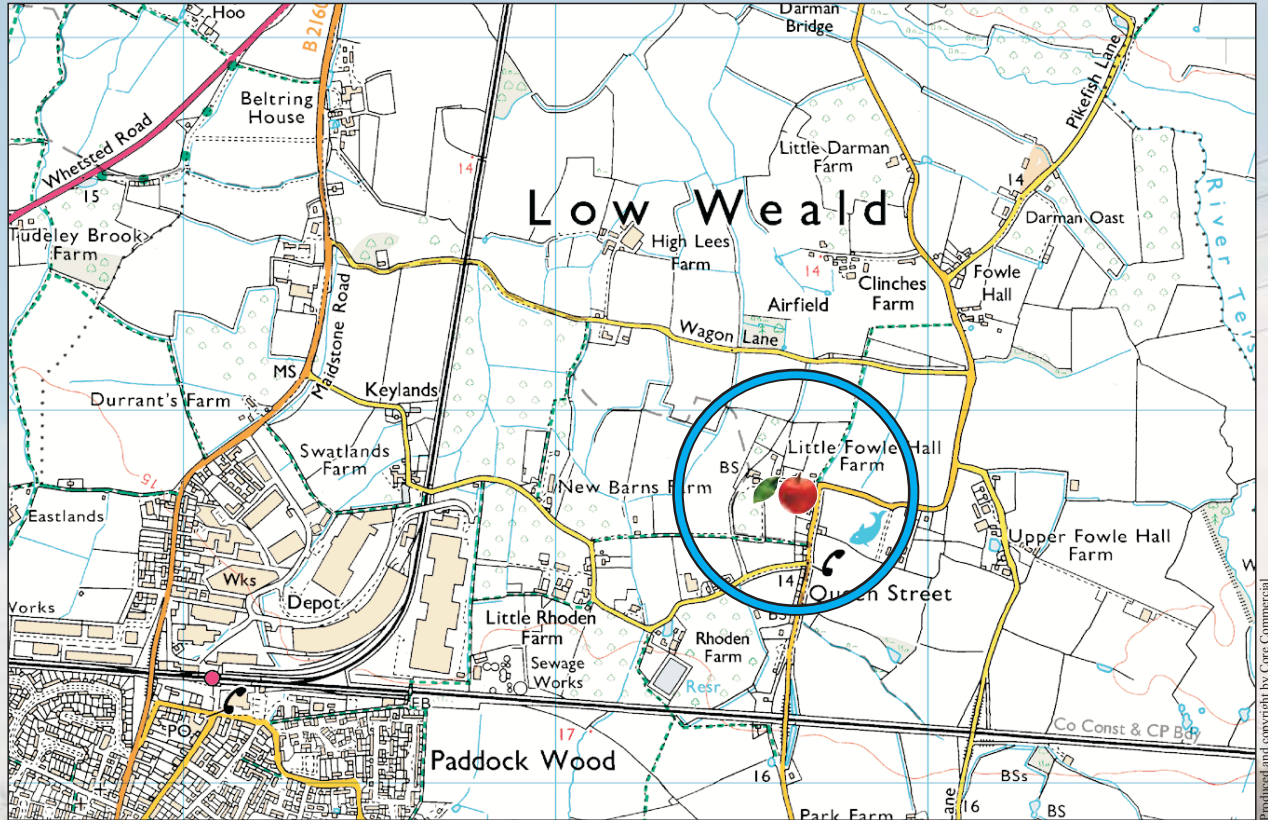

These particulars are provided in good faith but do not form part of a contract. No statements are to be relied upon as statements of fact and parties intending to rely upon the information for any purpose whatsoever must satisfy themselves by inspection or otherwise as to the correctness of each statement

 **CORE**
 COMMERCIAL
01892 834483
www.CoreCommercial.co.uk

David Marriott
 David@CoreCommercial.co.uk
 Neil Mason
 Neil@CoreCommercial.co.uk