

Offices To Let



Unit 11 Offices
Dana Estate
Transfesa Road
PADDOCK WOOD
Kent TN12 6UT

Location

Paddock Wood is located 45 miles south east of central London, 10 miles south west of Maidstone and 8 miles north east of Tunbridge Wells. The offices are a 5 minute walk from Paddock Wood railway station, 10 minute from high street shops.

Description

Basic but attractive offices with spacious marbled entrance. Carpeting, recessed lighting, M&F toilets & shared kitchen. Central heating. 24 hour usage. **Good car parking.**

200 to 2,340 sqft

Terms

To Let on flexible terms **£10 per sqft**, plus vat & services. Business rates to be re-assessed.

200 to 2,340 sqft

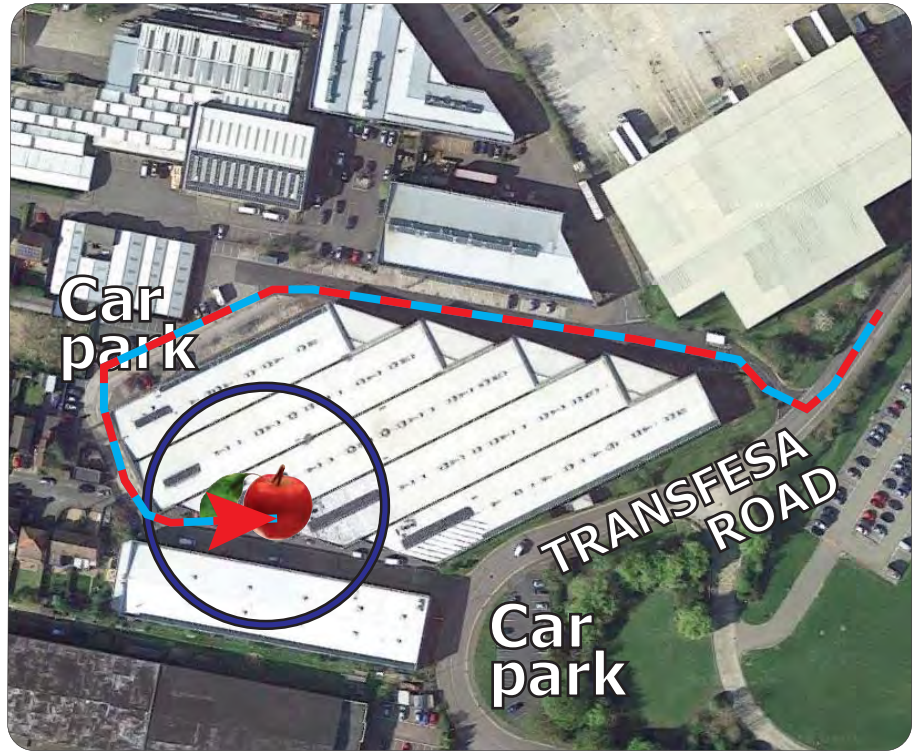

CORE
COMMERCIAL
01892 834483
www.CoreCommercial.co.uk

David Marriott
David@CoreCommercial.co.uk
Neil Mason
Neil@CoreCommercial.co.uk

These particulars are provided in good faith but do not form part of a contract. No statements are to be relied upon as statements of fact and parties intending to rely upon the information for any purpose whatsoever must satisfy themselves by inspection or otherwise as to the correctness of each statement.

Core Commercial Limited, Unit 11 Offices, Dana Estate
Transfesa Road, Paddock Wood, Kent TN12 6UT

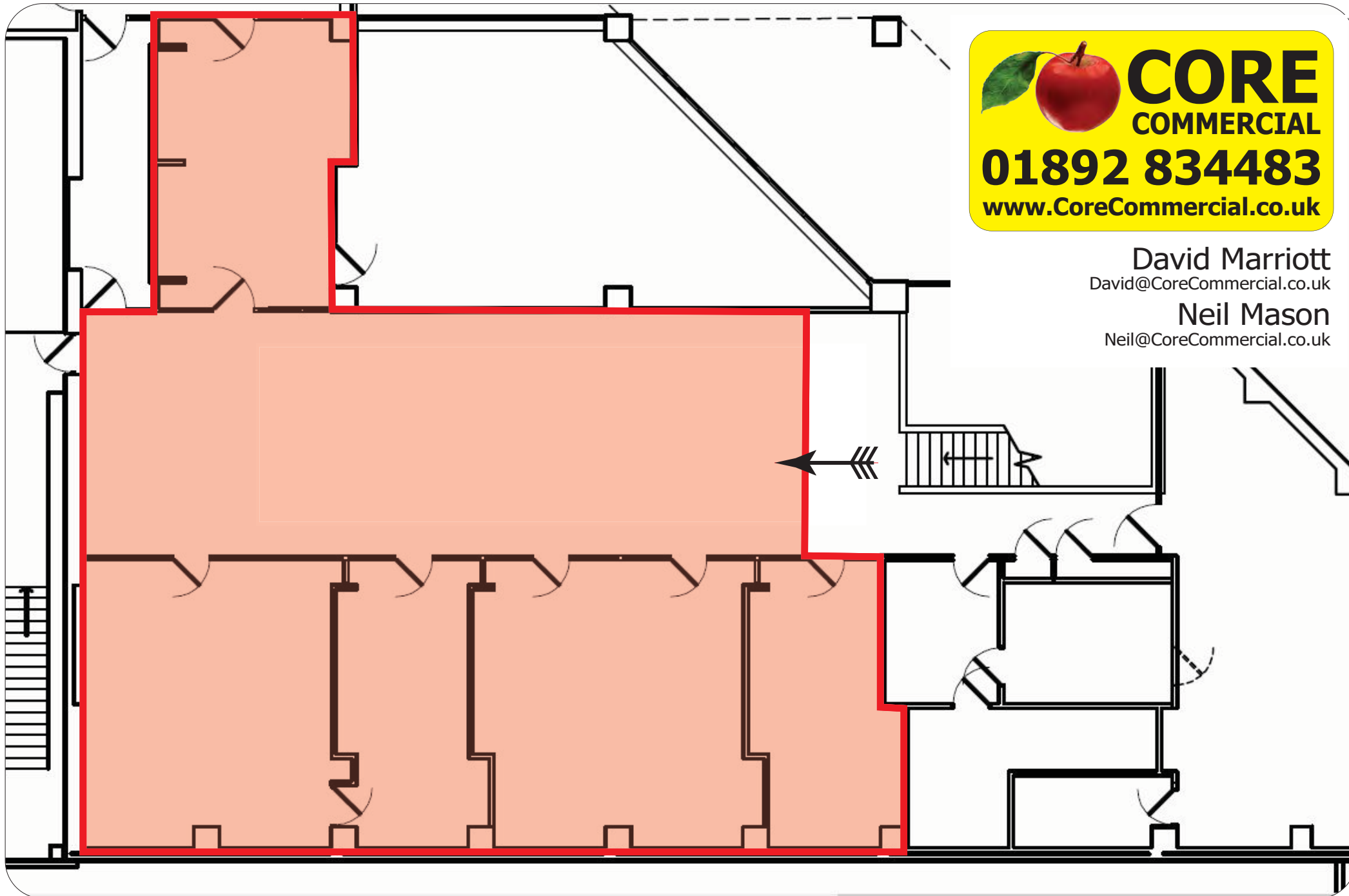

CORE
COMMERCIAL
01892 834483
www.CoreCommercial.co.uk

David Marriott
David@CoreCommercial.co.uk
Neil Mason
Neil@CoreCommercial.co.uk

These particulars are provided in good faith but do not form part of a contract. No statements are to be relied upon as statements of fact and parties intending to rely upon the information for any purpose whatsoever must satisfy themselves by inspection or otherwise as to the correctness of each statement.

Transfesa Road, Paddock Wood, Kent TN12 6UT