

Warehouse / Workshop To Let

CORE
COMMERCIAL
01892 834483



1E Marley Business
Centre, Headcorn
Road, Smarden

HEADCORN

Kent TN27 8PJ

Location

Headcorn is situated on the A247 southeast of Maidstone and west of Ashford. The property is located in a rural position on the Marley Farm estate due east of Headcorn.

Description

A mid terrace industrial/warehouse unit of concrete frame construction. New insulated folding door with pedestrian access. Lighting and 3 phase power. Eaves max: 18'4", min: 13'3". Asbestos cement roof covering. Easy access toilet and kitchen. Good parking. Ground Floor dimensions: 73'7" x 28'2".

2,090 sqft

plus 890 sqft mezzanine

Terms

To Let at **£16,950** per annum plus VAT. May sell freehold. Rates Payable for 2024/25: £2,162 if this is your sole commercial property (Rateable Value: £13,000).

Eligible Business Rates Relief
May sell freehold



2,090 sqft

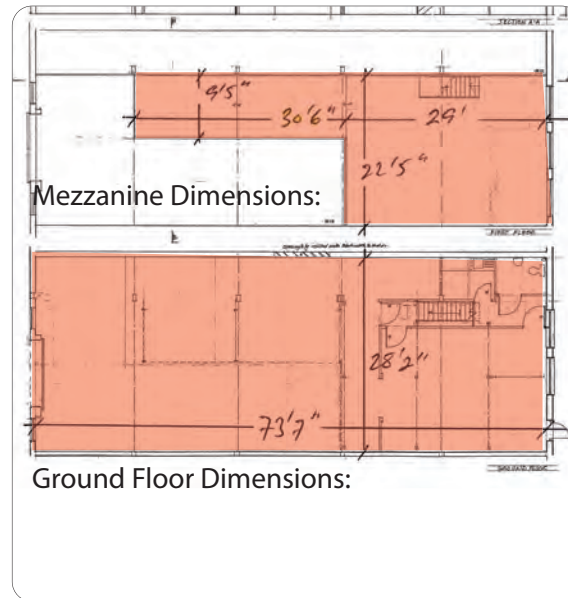
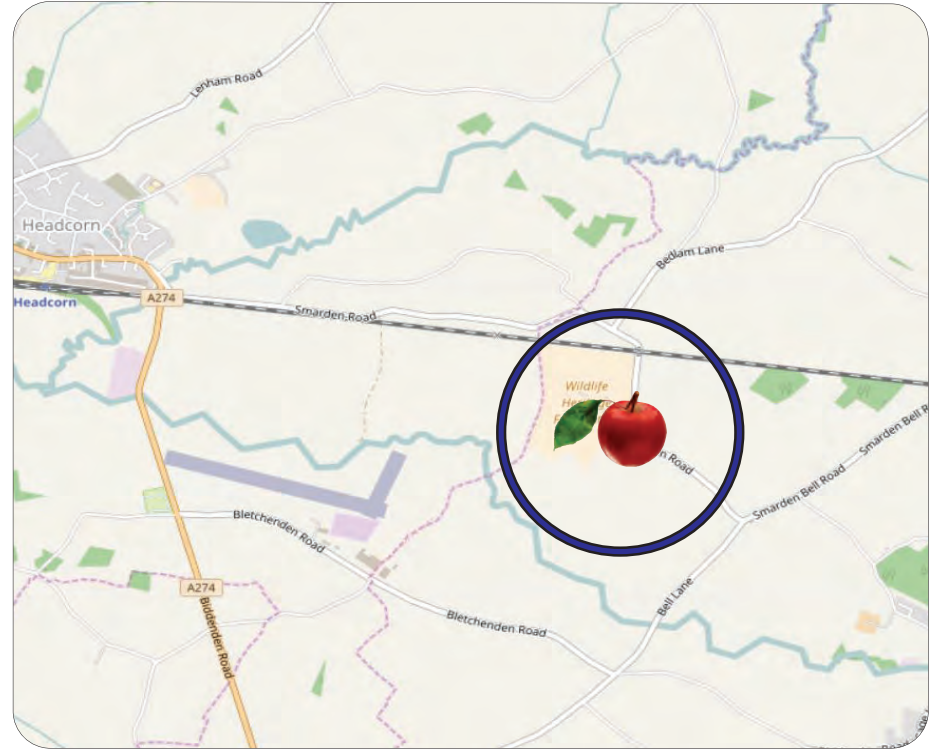
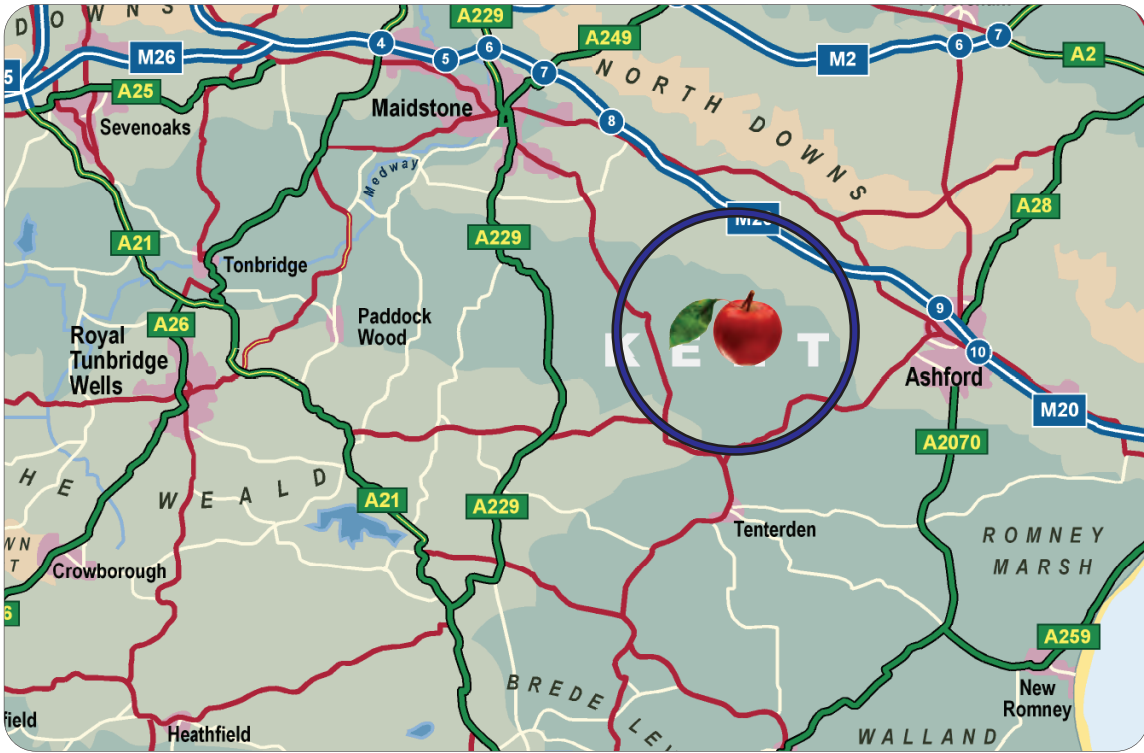

CORE
 COMMERCIAL
 01892 834483
 www.CoreCommercial.co.uk

Neil Mason
 Neil@CoreCommercial.co.uk

David Marriott
 David@CoreCommercial.co.uk

Core Commercial Limited, Webbs Court,
 1 Buckhurst Avenue, Sevenoaks, Kent TN13 1LZ

These particulars are provided in good faith but do not form part of a contract. No statements are to be relied upon as statements of fact and parties intending to rely upon the information for any purpose whatsoever satisfy themselves by inspection or otherwise as to the correctness of each statement.