

Showroom & Offices To Let



Unit A3
Lion Business Park, Dering Way
GRAVESEND
Kent DA12 2DN

Location

Gravesend is located in North Kent between Dartford and the Medway towns, approx. 20 miles south east of central London. Dering Way is just off the A226 Rochester Road / Milton to the East of Gravesend Town Centre.

Description

Modern showroom & offices brick and profiled steel elevations. 3 phase power. Sectional up and over doors to rear of showroom. Aluminium windows. Fully fitted offices. Kitchen point. Toilets.

Ground	3 606
First	3 616
	7,222 sqft

Good parking - approx 1/3 acre (15,000 sqft).

Terms

To let at **£70,000** pa plus VAT and service charge. Rates payable 2015/16 £28,348 (Rateable Value £57,500)



7,222 sqft

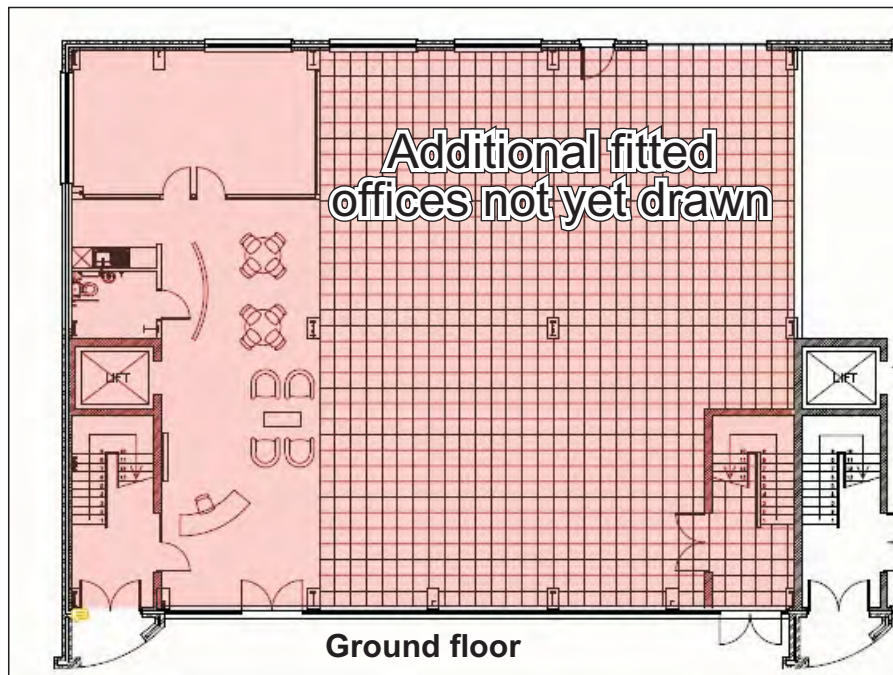

 **CORE**
COMMERCIAL

01892 834483

www.CoreCommercial.co.uk

David Marriott
David@CoreCommercial.co.uk

Neil Mason
Neil@CoreCommercial.co.uk

Stephen Smith
Stephen@CoreCommercial.co.uk