

Office Suites To Let

CORE
COMMERCIAL
01892 834483



Unit 11 Offices
Dana Estate
Transfesa Road
PADDOCK WOOD
Kent TN12 6UT

Location

Paddock Wood is located 45 miles south east of central London, 10 miles south west of Maidstone and 8 miles north east of Tunbridge Wells. The offices are a 5 minute walk from Paddock Wood railway station, 10 minute from high street shops.

Description

Basic but attractive offices with spacious marbled entrance. To be refurbished Carpeting, recessed lighting, M&F toilets & shared kitchen. Central heating. 24 hour usage. **Good car parking.**

Office 2 – 196 sqft

Office 3 – 396 sqft

Office 4 – 196 sqft

Office 5 – 400 sqft

Terms

To Let on flexible or short term terms at **£18 per sqft to include service charge and insurance** plus vat. Likely no Business rates if this is your sole commercial property.

Flexible or short term terms

196 to 1,188 sqft

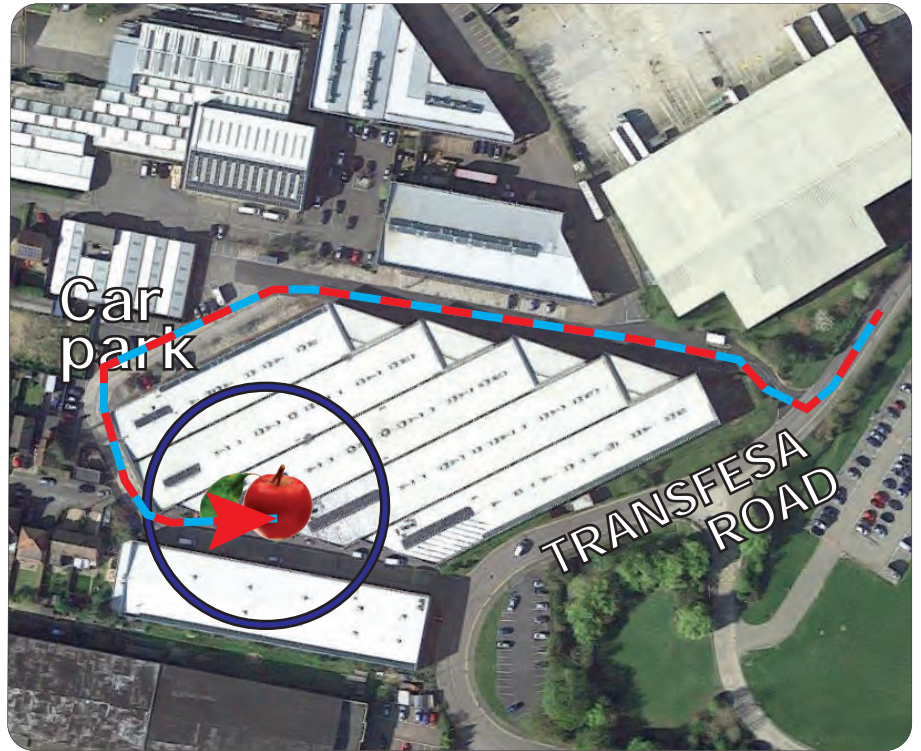
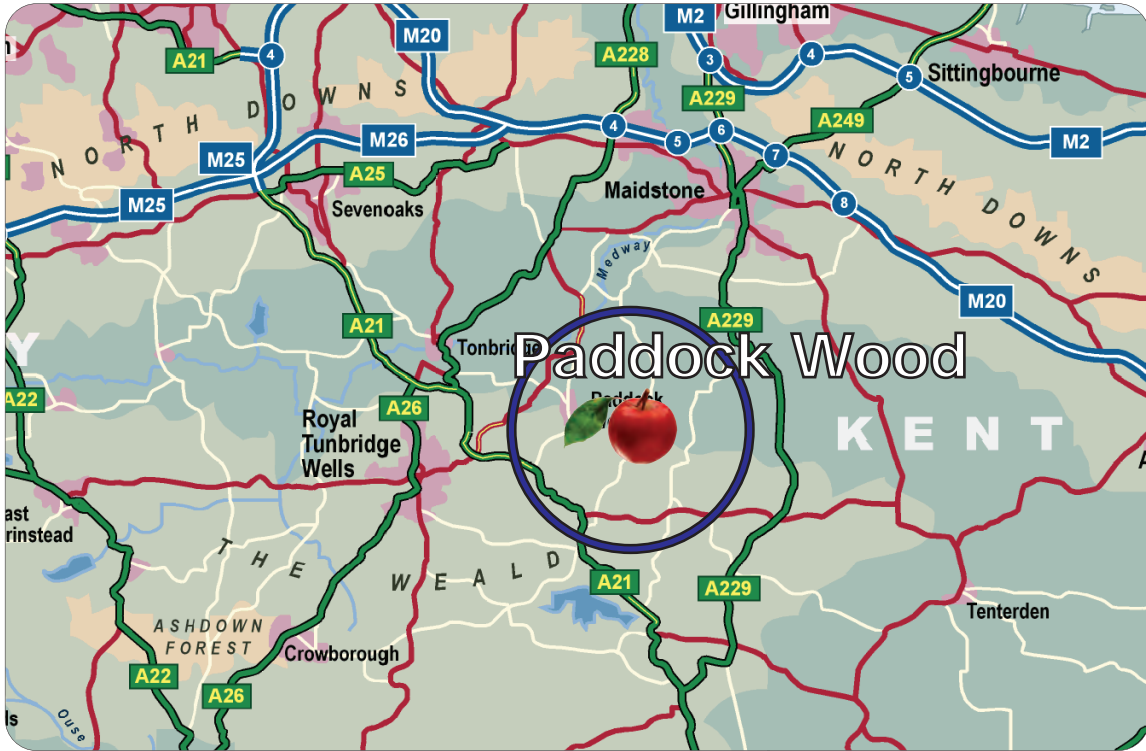



CORE
 COMMERCIAL
01892 834483
www.CoreCommercial.co.uk

Neil Mason
Neil@CoreCommercial.co.uk

David Marriott
David@CoreCommercial.co.uk

Core Commercial Limited, Nettlestead House,
 Maidstone Road, Paddock Wood, Kent TN12 6DA
 and 6 Kevington Close, Orpington, Kent BR5 2NX

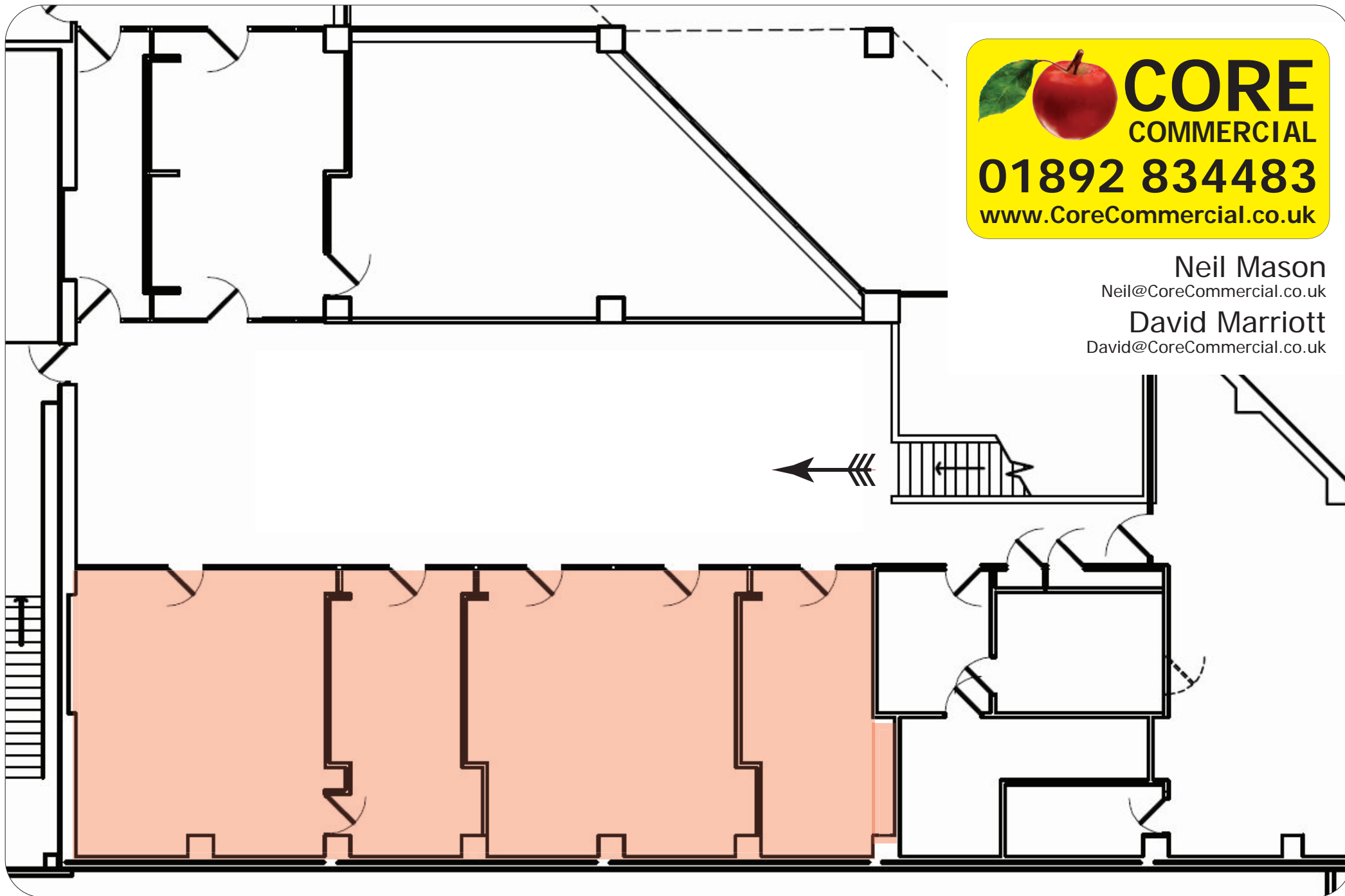
These particulars are provided in good faith but do not form part of a contract. No statements are to be relied upon as statements of fact and parties intending to rely upon the information for any purpose whatsoever must satisfy themselves by inspection or otherwise as to the correctness of each statement.



CORE
COMMERCIAL
01892 834483
www.CoreCommercial.co.uk

Neil Mason
Neil@CoreCommercial.co.uk
David Marriott
David@CoreCommercial.co.uk

These particulars are provided in good faith but do not form part of a contract. No statements are to be relied upon as statements of fact and parties intending to rely upon the information for any purpose whatsoever must satisfy themselves by inspection or otherwise as to the correctness of each statement.